

- Capacity 10 – 530 l/min
- 2" connections
- Suitable for viscosity liquids >3000 cP
- Max. sizes solid parts in liquid 6 m
- Viscosity up to 30 000 cP
- Pump body: Alu. (Komaxit coated)
- Low noise (75 dBa)
- Low air-consumption !
- Dry running capability
- Low maintenance and parts costs
- Bolted (SST) leakage free design
- No Air leakage at liquid stop



**Each pump tested
Test report included**

APPLICATIONS

CHEMICALS • SOLVENTS • PLATING • ACIDS • OILS • INKS • GLUES • ALKALIES • ENAMEL
POLYESTER PAINT • WASTE WATER • COOLING LIQUIDS • FOAMS • HYDRAULIC OILS

Flowchart 2" Series

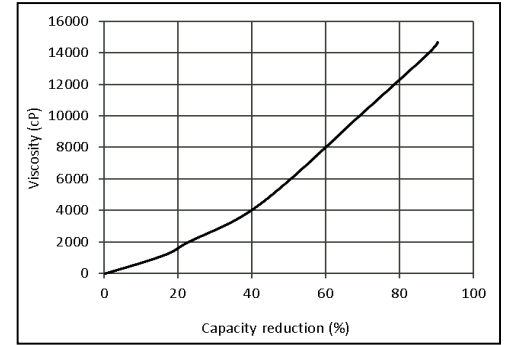
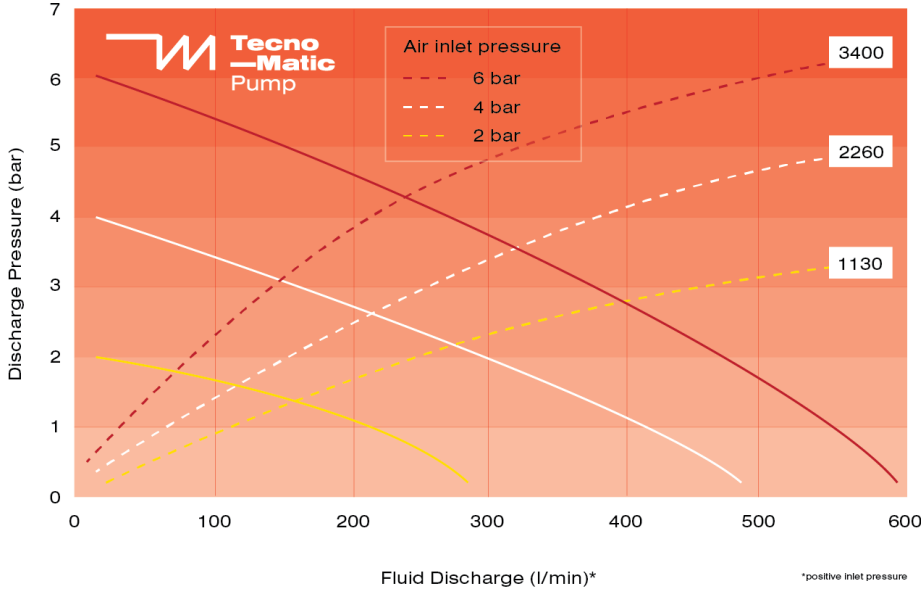

Air Consumption (NI/min)

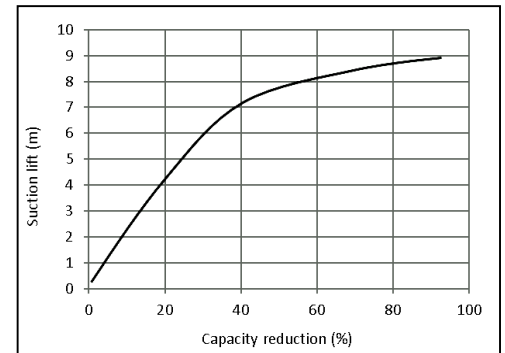

Available types

Type
TM3-530/2"-A-ST-ST
TM3-530/2"-A-NBR-NBR
TM3-530/2"-A-T-T

Max. weight: 35 Kg

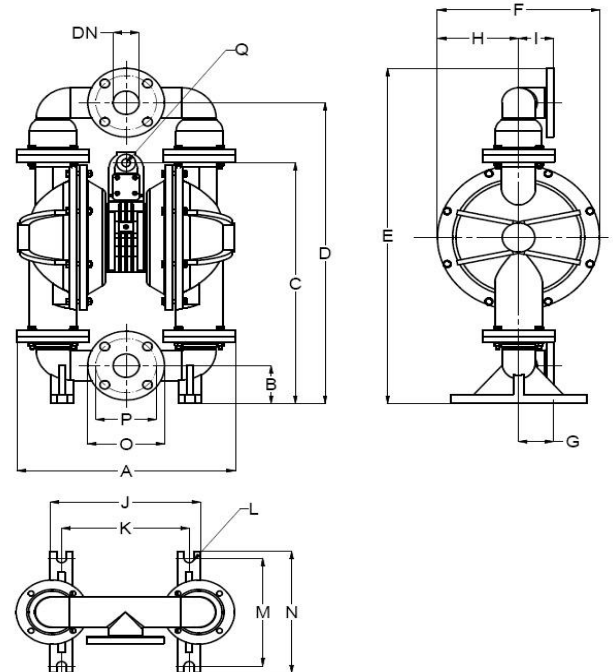

A	435 mm	G	70 mm	M	240 mm
B	84 mm	H	162 mm	N	270 mm
C	535 mm	I	70 mm	Q	½" female
D	669 mm	J	299 mm	O	153 mm
E	746 mm	K	254 mm	P	121 mm
F	323 mm	L	20 mm	DN	52 mm