

- Capacity 5 – 260 l/min
- 1-1/2" connections
- Pump body: HDPE, PP, PTFE
- Ceramic air-valve system
- ATEX version up on request
- Max. sizes solid parts in liquid 4 mm
- Viscosity up to 30 000 cP
- Low noise (77 dBa)
- Low air-consumption
- Dry running capability
- Low maintenance and parts costs
- Bolted (SST) leakage free design
- No air leakage at liquid stop



**Each pump tested  
Test report included**



**ATEX Version up on request**

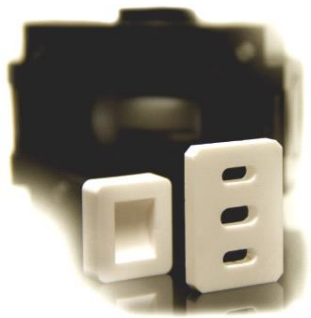

**Maintenance Free  
Ceramic Air-Valve Parts**

## APPLICATIONS

CHEMICALS • SOLVENTS • PLATING • ACIDS • OILS • INKS • GLUES • ALKALIES • ENAMEL  
POLYESTER PAINT • WASTE WATER • COOLING LIQUIDS • FOAMS • HYDRAULIC OILS

### Flowchart 1 1/2" Series

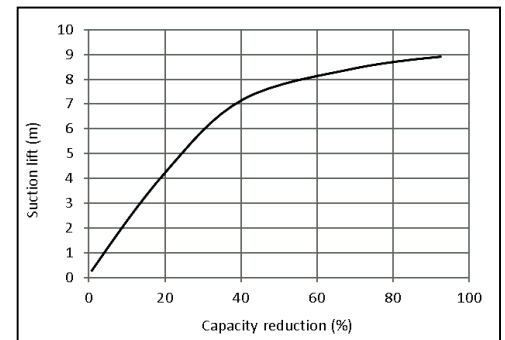
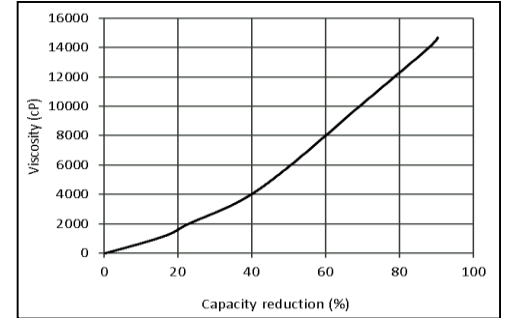
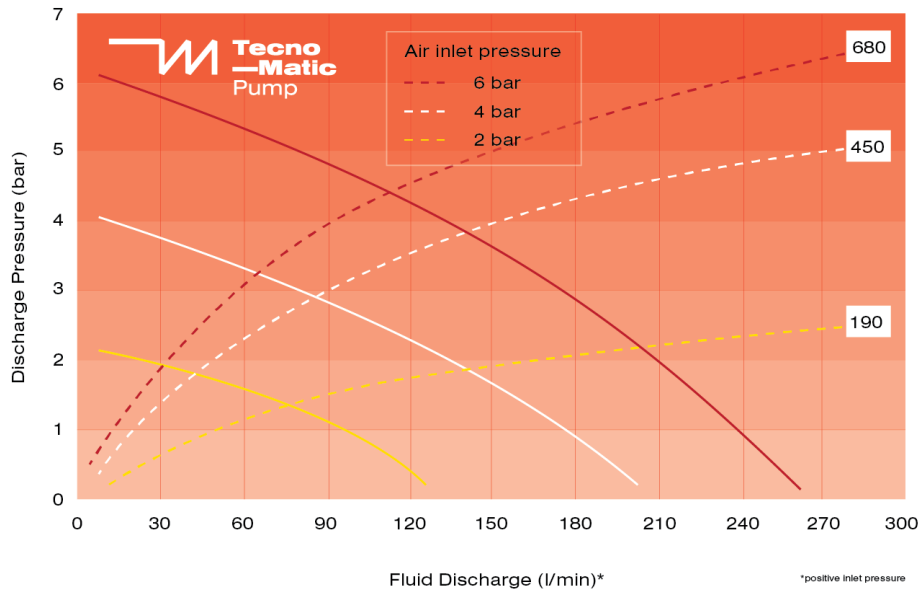

Air Consumption (Nl/min)

### Available types

Type
TM2-260/1.5"-HDPE-ST-ST
TM2-260/1.5"-HDPE-NBR-NBR
TM2-260/1.5"-HDPE-T-T
TM2-260/1.5"-P-ST-ST
TM2-260/1.5"-P-NBR-NBR
TM2-260/1.5"-P-T-T
TM2-260/1.5"-PTFE-ST-ST
TM2-260/1.5"-PTFE-NBR-NBR
TM2-260/1.5"-PTFE-T-T

Max. weight: 24 Kg

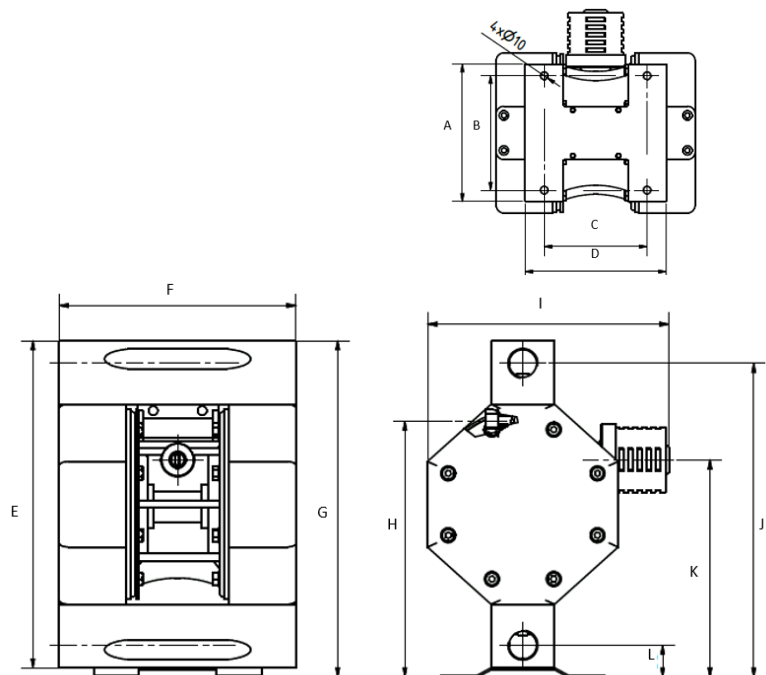

<b>A</b>	180 mm	<b>E</b>	360 mm	<b>I</b>	266 mm
<b>B</b>	150 mm	<b>F</b>	261 mm	<b>J</b>	345 mm 1"
<b>C</b>	135 mm	<b>G</b>	370 mm	<b>K</b>	239 mm
<b>D</b>	185 mm	<b>H</b>	282 mm	<b>L</b>	30 mm 1"